

Student Success Newsletter

St. Philip's College, 1801 Martin Luther King Dr., San Antonio, TX 78203
St. Philip's College - Southwest Campus, 800 Quintana Rd., San Antonio, TX 78211

Student Success Leadership Team



Dr. Mordecai Brownlee
Vice President for Student Success



Dr. Paul Machen, II
Dean for Student Success
(Educational Support Services)



Christina Cortez
Dean for Student Success
(Enrollment Management & Advising)

Editors: Rosalinda Rivas, Eitandria Tello

Quality Enhancement Plan – Ethical Decision-Making

St. Philip's College is accredited by the Southern Association of Colleges and Schools Commission on Colleges (SACSCOC). Part of this process is the QEP (Quality Enhancement Plan) to promote student success. Our QEP topic is Ethical Decision-Making.

QEP Focus: Ethical decision-making is the ability to connect values and choices to actions and consequences.

QEP Goal: Students engage in specific measurable academic activities to enhance their ethical decision-making skills.

Ethical Decision-Making Process:

- *Stop and think to determine the facts.
- *Identify the options.
- *Consider consequences for yourself and others.
- *Make an ethical choice and take appropriate action.



MESSAGE FROM OUR VICE PRESIDENT:

Greetings SPC Tigers –

Happy 4th of July and welcome to all of our new students. St. Philip's has an array of resources available to ensure your success as a student, so be sure to take a look at all of our student support resources listed on the our ["Remote Ready" website](#). Within this publication you will also find an array of information, all geared to support your academic pathway. Take care and know that St. Philip's College is committed to your success.

Dr. Mordecai Ivan Brownlee
Vice President for Student Success
St. Philip's College

Student Success in the SLC – MLK Campus

For more information, contact Charleen Brammer at 210-486-2468 or 210-486-2275.

SLC 102 Point of Contact

SPC Safe **SPACE** Advocacy Center
Counseling Services
Social Services Assistance
Disability Services
Service Learning/Financial Literacy
Student Conduct/Title IX Programs

Sasha Wilhelm
Sasha Wilhelm
Sasha Wilhelm
Maria Botello
Elizabeth Castillo
John Martin

SLC 127 Point of Contact

SPC Health Center

Elijah Casillas

Summer 2020 Hours of Operation

(Remote Access only):

New Hours!

June 1- July 24

Monday – Thursday
Friday

8:00 am – 7:00 pm
College Closed

Important Dates

July 2020 Census, US Census Bureau -- Submit your Census online – See link on page 6)

July 1 Last day to Withdraw (First Summer Session)

July 2 Independence Day Holiday (College Closed)

July 3, 10, 17 & 24 College Closed (4 Day Work Week)

July 8-9 Final Exams (First Summer Session)

July 13 Classes begin (Second Summer Session)

July 16 Last day to Withdraw (Eight Week Session);
Census Date (Second Summer Session)

July 29-30 Final Exams (Eight Week Session)

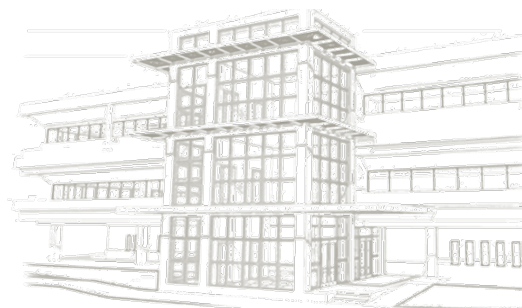



AlamoCARES

For more information, contact Dr. Mordecai Brownlee, Vice President of Student Success at 210-486-2252.

St. Philip's College is committed to providing a supportive learning environment and to fostering safe, healthy relationships among our students. In this effort, Alamo Colleges District initiated AlamoCARES, a prevention, education and support program regarding dating violence, domestic violence, sexual assault and stalking. It is our sincere hope that AlamoCARES will empower you to make well-informed decisions about life issues that affect your college years and beyond.

Within the AlamoCARES site, you will find information on rights granted by **Title IX** and resources to help educate and assist you when dealing with harassment and sexual violence. Coming soon are events, training and opportunities to bring awareness when dealing with difficult issues and creating discussion opportunities with students. Visit us at <http://alamo.edu/spc/alamocares/> for more information.

The Alamo Colleges District encourage individuals to bring forward information/complaints about sexual harassment and sexual violence. **Retaliation** against any **individual who reports or participates** in the investigation of alleged violations is **strictly forbidden** and will be **enforced** by the College administration.

If you believe you have experienced **Sexual Misconduct** you may consider the following options:

- Contact **Campus Police** at 210-485-0099 (non-emergency) or 210-485-0911 (emergency)
- Seek **medical attention** at a hospital or with a physician
- **Report the incident** at www.alamo.edu/TitleIXCoordinator/ (call John Martin 210-486-2746)
- **Contact SPC Counseling Services** at 210-486-2333 (for confidential counseling and or referrals)
- Contact **parents, relatives or close friends** for support

H.1.1 Equal Education and Employment Opportunities (Policy) www.alamo.edu/district/policies/

AlamoCARES has additional **Title IX** information and resources at: www.alamo.edu/spc/AlamoCARES

ATTENTION STUDENTS!

All entering freshmen, former and transfer students are now required to complete "**Sexual Assault Prevention for Community Colleges**". Sexual Assault Prevention for Community Colleges is an online survey and course addressing critical life skills. The training is our way of informing St. Philip's College students about **Title IX** standards, reporting violations and resources available. **All entering freshmen, former and transfer students are required to complete the training before the end of their first semester of classes at St. Philip's College (to avoid a registration hold being placed on their account).**

To access the Sexual Assault Prevention for Community Colleges training:

1. Always sign in through ACES at <https://alamoaces.alamo.edu>.
2. Look for the AlamoCARES box on the Student tab and read the important message before accessing the course. Note: an alternative training is available; see your Vice President for Student Success for assistance.
3. Click on the link provided, and complete the confidential pre-survey at the start of the course. The Alamo Colleges District does not receive a copy of your responses.
4. The quiz at the end of the course is required to document your completion, but the score is not recorded and will not impact you in any way. Completion is documented on your student record.

You Have the Right to Feel Safe.

Academic and Career Advising Services

For more information contact Arianna Lay at 210-486-2381.

The campus remains closed due to coronavirus, but teaching, learning, and staff support are provided remotely. Visit the [COVID-19 Update Page](#) or key in <https://coronavirus//www.alamo.edu/> to see the latest developments. Updates are posted as soon as they become available.

Fall registration is in full swing! Schedule your advising appointment today via Navigate to meet with your assigned advisor remotely!

Virtual drop-in Advising services are offered Mondays from 3:00 pm – 7:00 pm and Thursdays from 9:00am - 1:00 pm for quick questions via Zoom. You can email spc-advising@alamo.edu with your Banner ID to request the Meeting ID. Download the application on your smartphone or computer for instant access (no account required).

Zoom Advising Instructions in Navigate:

- Log in to your [ACES](#) Account
- Click on the "Start Here" tab
- Select the "Alamo NAVIGATE" icon
- Click "Login"
- Select the "Appointments" tab
- Select "Schedule an Appointment"
- Select the Reason for your appointment and hit Next
- Select the Location and hit Next
- Select the Day and Time that works for you and hit Next
- Enter "Zoom Appointment" in the Notes box
- Review the selection and confirm your appointment

Steps to identify who your Advisor is:

1. Log into ACES
2. Click on the **My Page** tab (4th tab from the left)
3. Under **Academic Profile** (on the left) select the **current term** and press **Go**
4. Your advisor's name will appear under "Advisors"
5. Visit your advisor

For more information visit

<https://www.alamo.edu/spc/academics/academic-resources/academic-advising/>.

Summer Hours of Operation:

June 1-July 24, 2020

(Due to 4-day work week)

Monday – Thursday (only) 8:00 am – 7:00 pm

August 3-August 28, 2020

Monday – Thursday 8:00 am – 7:00 pm

Friday 8:00 am – 5:00 pm

Saturday 9:00 am – 1:00 pm

Technical Support

Email: spc-helpdesk@alamo.edu

Phone: 210-486-777
(Choose **Option 1** for technical support)

 ALAMO COLLEGES AlamoINSTITUTES	
An organization of six career pathways designed for students who have key interests, such as, but not limited to the following areas:	
Creative & Communication Arts Institute	<i>The Arts, Audio/Video Technology and Communications*</i>
Business & Entrepreneurship Institute	<i>Business Management & Administration, Finance, Hospitality & Tourism, and Marketing*</i>
Health & Biosciences Institute	<i>Health Sciences*</i>
Advanced Manufacturing & Logistics Institute	<i>Architecture, Construction, Manufacturing, Transportation, Distribution & Logistics*</i>
Public Service Institute	<i>Education, Training, Government, Public Administration, Human Services, Law, Public Safety, Correction and Security*</i>
Science & Technology Institute	<i>Agriculture, Food & Natural Resources, Information Technology, Science, Technology, Engineering and Mathematics*</i>

Academic and Career Advising Services (continued)

For more information contact Arianna Lay at 210-486-2381.

New Student Orientation (NSO):

New Student Orientation is mandatory for all First Time in College, Returning, and Transfer students planning to enroll at SPC. By completing your New Student Orientation Canvas course you will become more familiar with the college lingo, college resources, college policies/procedures, learn about payment and financial aid options, and academic advising.

NSO has moved remotely to a Canvas platform and is accessible via your student ACES portal within 2-3 business days upon successful completion of the Online Registration Form. The preferred browser for the course is Google Chrome. All students must have a current/active admissions application on file to register and participate in the Canvas course.

Please visit our NSO site here: <https://www.alamo.edu/spc/academics/academic-resources/academic-advising/new-student-orientation/>.

Group Advising (GA): Group Advising provides students with a small group and one-on-one advising assistance for registration for new or returning students. Students are provided information about their certification, degree, and/or transfer advising guide as well as provided guidance on selecting and registering for classes for the upcoming semester.

Students must complete all steps in the Enrollment Process and NSO to schedule a Group Advising session after completion of New Student Orientation. Failure to complete any or all parts or both the enrollment process or Canvas course in ACES will hinder your ability to register.

Steps in the Enrollment Process include:

- Complying with the bacterial meningitis law
- Completing the Go FAARR and Test Prep Modules
- Taking the TSI Placement Exam or providing qualifying exemption scores
- Complete Refresher courses (if applicable)

Laptop and Internet Hotspot Check-Out for Students:

Connect with Information Technology at your home college to access this no-cost program. **Choose Option 1**, and let us know how we can help:

SAC: 210-486-0777 **NVC:** 210-486-4777

SPC: 210-486-2777 **NLC:** 210-486-5777

PAC: 210-486-3777

Career Services: We have the resources and network to help you explore and develop your career goals. Through self-assessment and career exploration, you will be able to ensure that the Alamo Institute you selected upon enrollment is a great fit for your career and educational needs. Learn more about our career related services at <https://www.alamo.edu/spc/experience-spc/current-students/career-services/> or contact Advising Team Leader Gilbert Palomo via email (spc-jobs@alamo.edu), or at 210-486-2056.



There is still time to register online for Summer II. Registration ends July 5 (classes begin July 13). Contact your Certified Academic Advisor for help with registration!

Active Duty Students with questions, concerns or comments may be directed to the JBSA Advising staff:

Fort Sam Students

Allison Joubert
210-486-2004

Randolph Students

Cynthia Jaime
210-486-2901

Lackland Students

Javier Barron
210-486-2901

General Information

Sarai Duran
210-486-2001

dst-military@alamo.edu

Academic and Career Advising Services (continued)

For more information contact Arianna Lay at 210-486-2381.



SPC Academic and Career Advisors:

Institute 1: Creative & Communication Arts

Konnie Harper-Thompson
kharper-thompson@alamo.edu

Institute 2: Business & Entrepreneurship

Yolanda Ward yward@alamo.edu
James Satchell jsatchell@alamo.edu
Joseph Hernandez jhernandez31@alamo.edu

Institute 3: Health & Biosciences

Frances Calderon fcalderon4@alamo.edu
Irma Lopez isanchez17@alamo.edu
Teresa Hopwood thopwood2@alamo.edu
Tricia McElligott tmcelligott@alamo.edu
Nathaniel Martinez nmartinez324@alamo.edu
Doug Gable dgable@alamo.edu
Jessica Perez jperez1494@alamo.edu
Juan Venegas jvenegas21@alamo.edu
Xavier Toussaint xtoussaint@alamo.edu

Institute 4: Advanced Manufacturing & Logistics Automotive Technology (MLK Campus)

Yvonne Benton ybenton@alamo.edu
Christine Saucedo csauceda1@alamo.edu

Institute 4: Advanced Manufacturing & Logistics (Southwest Campus)

Blair Hannon bhannon@alamo.edu
Sarah Ramirez sramirez260@alamo.edu
Jennifer Salmeron jleal@alamo.edu
Carlos Solis csolis@alamo.edu

Institute 5: Public Service

Yvonne Benton ybenton@alamo.edu
Christine Saucedo csauceda1@alamo.edu

Institute 6: Science & Technology

Meredith Bess mbess@alamo.edu
Gloria Jose [giosse@alamo.edu](mailto:giose@alamo.edu)
Xavier Toussaint xtoussaint@alamo.edu

SPC Advising welcomes our newest Certified Academic Advisors, Brandy Lewis and Shannon Johns!

Laptop & Internet Hotspot Check-Out Available for Students

Loaner laptop computers and internet hotspots are available for students at no cost. Eligible students should contact SPC's [Information Technology \(IT\) Services](#) at 210-486-2777, or via email at spc-helpdesk@alamo.edu to inquire about the check-out process. Review these important guidelines:

Limits and Guidelines

- Students must be actively enrolled at St. Philip's College ***
- SPC must be your home campus ***
- Laptops and internet hotspots should be used for educational purposes only
- Eligible students may check-out only one laptop and/or one hotspot
- Students may not alter, delete, copy, or tamper with software loaded on the laptop or change its configuration
- SPC is not responsible for damage to any external device (i.e. a flash drive or other device) or for the loss of data that may occur while the laptop is in use
- Technical Support and Software Application questions may be directed to SPC's [IT Services](#) at 210-486-2777 (choose **Option 1**)

A limited number of equipment is available. Find additional resources and technical support at <https://www.alamo.edu/spc/experience-spc/current-students/student-resources/technical-support/>. WiFi is available at MLK Lot P12. Lot P13 will be closed until further notice. See MLK Campus WiFi Map <https://www.alamo.edu/siteassets/spc/experience-spc/current-students/student-resources/technical-support/documents/campusmapmlk-wifi.pdf>.

2020 Census – U.S. Census Bureau

Fill out your census online, by phone or mailing in the form. Participating is your chance to help your county get its fair share of representation and funding. For more information and to fill out your census in Spanish call: 1-844-468-2020 (see <https://2020census.gov/> for other languages). Click the banner below or go to <https://www.sabexarcourtmein.org/> to get counted now!

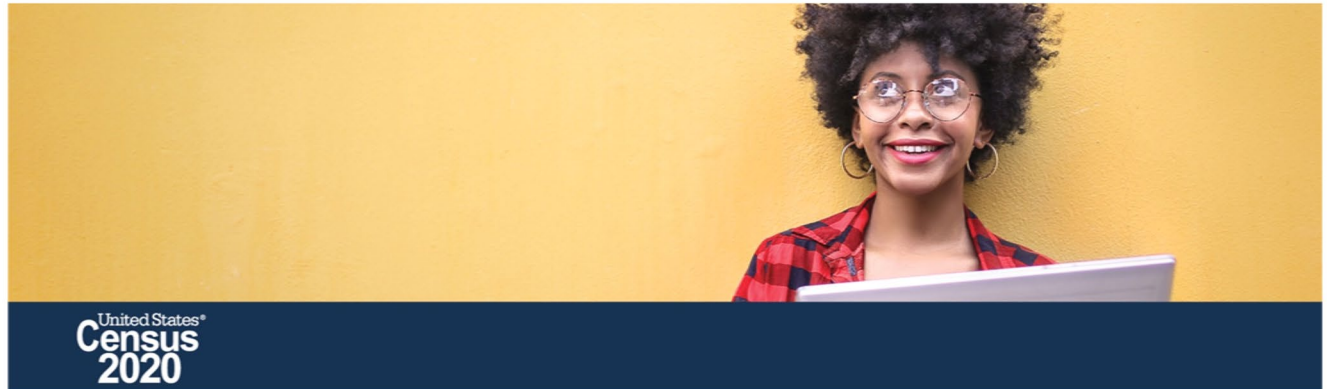

Alumni Affairs

For more information contact Dr. Sharon Crockett-Ray at 210-486-2887.

If you are looking for a way to stay in touch with SPC, there is no better way than joining the Alumni and Friends Association. Membership information is at <https://www.alamo.edu/spc/alumni-affairs/>, or follow us on Facebook: <https://www.facebook.com/gospc>.

BAE-B-SAFE

For more information contact Tracy Watts at 210-486-2538.



BAE-B-SAFE is currently offering online sexual health education programs for females between the ages of 14-19. The session only takes one hour and participants will receive a \$20 electronic gift card. Contact Tracy Watts for more information at twatts8@alamo.edu, or by phone at 210-486-2538. To find out more about the BAE-B-SAFE Program go to: <https://www.hf-tx.org/baebSAFE>.

Healthy Futures of Texas: 210-223-4589 – Access resources for youth homelessness, sex and health education, relationships, dating, support, and more during COVID-19 at <https://www.hf-tx.org/>.

Bookstore

For more information contact Jorge Marines at 210-534-8024.



BOOKSTORE
St. Philip's
College

Campus Stores are closed due to COVID-19 until further notice. You can still shop for your textbooks online or locate course materials at <https://www.bkstr.com/stphillipsstore>. Contact us at 210-534-8024 or via email at stphilips@bkstr.com to inquire about textbook options, digital downloads, discounts on technology, and more.

Business Office

For more information contact Sofia Zavala at 210-486-2247.



Keep Learning Plan at St. Philip's College! See page 10. The Keep Learning Plan can work for you. Eligible students can save time and money. We can answer questions about billing for the **new Expanded Summer Momentum program**, the **new Reduced Payment Plan**, or tuition discounts and waivers. Stay on track for a degree with the **new Clean Slate Plan**. Find out more at <https://www.alamo.edu/cleanslate>, and <https://www.alamo.edu/admission--aid/paying-for-college/tuition-and-fees/summer-momentum-plan/>. Call Sofia Zavala (210-486-2247), email dst-vbo2@alamo.edu, or visit <https://www.alamo.edu/district/business-office/> to learn more. Provide your name, telephone number, email address, and Banner ID when calling or emailing.

Child Development Center

For more information contact Monica Guzman at 210-486-2501.

We are offering free virtual summer activities for children and student parents through July 31 via Zoom. Early childhood professionals are available throughout the week for parenting advice. For the schedule of activities contact Aileen Hartfield at 210-486-2500, or at ahartfield5@alamo.edu. Children registered for summer activities will be transitioned to the Fall 2020 childcare roster. Grant based tuition subsidies are available for the Fall session. Learn more at <https://www.alamo.edu/spc/news-events/news/2020/may/spcs-child-development-center-offers-virtual-summer-activities/>.



Counseling Services

For more information contact Sasha Wilhelm at 210-486-2827.

We provide counseling support via Zoom. Call us at 210-486-2333 to schedule an appointment (provide your name, telephone number, and Banner ID when calling or emailing). Community residents needing resources or assistance due to COVID-19 may call **United Way of San Antonio and Bexar County's 2-1-1 Help Line**. In case of an emergency call **The Center for Healthcare Services Crisis Hot Line** at 210-223-7233, or dial **9-1-1**.

College students talk to Counselors about many different types of issues like career concerns, anxiety, academic stress, relationships, stress associated with deportation/family legal status, trauma, coping with illness, and more. Counselors also provide referrals and community resources. Make an appointment if you want to talk about strategies that can help you manage your stress, school and life activities. See important links on our website: <https://www.alamo.edu/spc/experience-spc/current-students/safe-space/counseling-services/>.

DACA Allies: Find resources for scholarships and legal assistance for Deferred Action for Childhood Arrivals (DACA) at <https://www.alamo.edu/spc/admissions/specific-populations/daca/>, or speak confidentially to District Coordinator Carmen de Luna Jones (210-485-2080), SPC Director Elizabeth Castillo (210-486-2473), or SPC Counselor Rosalinda Rivas (210-486-2117).

Substance Abuse and Mental Health Services Administration (SAMHSA)
1-800-662-4357
TTY: 1-800-487-4889
Treatment referral and info 24/7
www.samhsa.gov/find-help/national-helpline

St. Philip's College is committed to providing a supportive learning environment and to fostering safe, healthy relationships among our students. For more information visit <https://www.alamo.edu/spc/experience-spc/current-students/safe-space/counseling-services/>

July is National Minority Mental Health Awareness Month. Connect with a Counselor today.

The SPC Safe **SPACE** Student Success & Advocacy Center

For more information contact Sasha Wilhelm at 210-486-2827.

The campus remains closed due to COVID-19, but teaching, learning, and staff support are provided remotely. Please visit the [COVID-19 Update Page](#) or key in <https://coronavirus/www.alamo.edu/> to see the latest developments.



Helping Students Succeed at SPC: The SPC Safe **SPACE** Student Success & Advocacy Center provides resources for food and social services assistance, and possible access to a one-time emergency aid program through Trellis. Let us know how we can help. For more information contact Sasha Wilhelm via email at awilhelm3@alamo.edu (or at 210-486-2827). Provide your name, telephone number, and Banner ID when calling or emailing.

Important Services and Resources:

Alamo Colleges Helpline (210-486-1111): Call the Helpline to connect with state benefits and locate important resources. The Helpline is available 8 am-7 pm, Monday-Thursday, in accordance with the 4-day work week.

The San Antonio Food Bank website is <https://safoodbank.org/cvresponse/>.

United Way - COVID-19 Resources and Assistance: Get help – dial 2-1-1. This is a free, anonymous social service hotline that helps people find information about local resources in their community, and is accessible 24/7 including holidays. Spanish and Language Line translation are available. The Alamo Region is comprised of Bexar and eleven surrounding counties. If unable to reach 2-1-1 from your telephone, call 1-877-541-7905, or access the online database at <https://www.211texas.org/>. United Way assists with food, clothing, shelter, school district meal programs, child care resources, internet resources, employment, medical/dental care, legal help, veterans' services, counseling/mental health, parenting, smoke detectors, Project Cool (free box fans for seniors) and more. Visit <https://www.unitedwaysatx.org/2-1-1/>, or <https://www.unitedwaysatx.org/covid19/>.

Texas Health & Human Services is offering COVID-19 Pandemic-EBT (P-EBT), a one-time benefit for eligible families that have lost access to free or reduced-price meals because of closures related to COVID-19. Learn more at <https://hhs.texas.gov/services/health/coronavirus-covid-19/coronavirus-covid-19-information-texans/pandemic-ebt-p-ebt-due-covid-19>. Ayuda en Español. Para informarse sobre los requisitos del programa y cómo solicitar estos beneficios, vea las siguientes preguntas frecuentes y más: <https://hhs.texas.gov/es/servicios/salud/sesion-informativa-de-medicaid-chip-sobre-covid-19/transferecia-electronica-de-beneficios-durante-la-pandemia-p-ebt-por-el-covid-19>.

City of San Antonio COVID-19 Emergency Housing Assistance Program

San Antonio residents can find more information on the program by calling 210-207-5910, or apply online now at <https://www.sanantonio.gov/NHSD/Programs/FairHousing>. Residents must meet eligibility requirements.

The program can help with:

- Rent or mortgage payments
- Electricity and water bills
- Internet and phone bills
- Groceries, Medicine, Fuel

Encountering online issues due to the high volume of requests? Consider completing the online application early/late in the day.

Resources: • National Domestic Violence Hotline Staying Safe During COVID-19: 1-800-799-7233, and TTY 1-800-787-3224 • The National Network to Eliminate Domestic Violence, Resources on the Response to the Coronavirus (COVID-19): <https://nnedv.org/get-help/> • Department of Justice, Office of Women's Health: <https://www.justice.gov/ovw/local-resources> • Prevent Child Abuse America, Coronavirus Resources & Tips for Parents, Children & Others: <https://preventchildabuse.org/coronavirus-resources/> • Stronghearts Native Helpline: 1-844-762-8483, or visit <https://www.strongheartshelpline.org/> • Informed Immigrants, Resources for immigrants during the Coronavirus crisis: <https://www.informedimmigrant.com/guides/coronavirus/> • CDC, Preventing Intimate Partner Violence: 1-800-CDC-INFO (232-4636), and <https://www.cdc.gov/violenceprevention/intimatepartnerviolence/fastfact.html>.

How to get Alamo Alerts (RAVE)

Make Sure that YOU get Alamo Colleges Alamo Alerts: Alamo Colleges email addresses are automatically subscribed to the Alamo Alert System. Log on to www.getrave.com/login/alamo to update your profile. We highly encourage you to add your mobile phone.

Note: If you have already entered your mobile number in our previous Alamo Alert System, all you have to do is log in and confirm your mobile number. If you have never entered your mobile number, you will not receive text alerts on your cell phone.

- The weather line: **210-485-0189** • Campus Police 24-hr. Dispatch: **210-485-0099**
- Campus Police Emergency: **210-485-0911** • Learn more at <https://www.alamo.edu/about-us/our-district/contact-us/emergency/alamo-alert/>, or contact Will Davis via email at wdavis1@alamo.edu, or by phone at **210-485-0063**.

Disability Services

For more information contact Maria Botello at 210-486-2199.

Disability Services ensures reasonable academic support to qualifying students with disabilities. We want to make sure you get the support you need to complete your courses successfully. To get support with disability services (Establishing or Renewing Services, TSI Testing, Academic Advising, Course Accommodations, or Assistance with online adaptive resources) please contact us at spc-dss@alamo.edu or call (210) 486-2199. Please provide your name, telephone number, email address, and Banner ID when calling or emailing.

For more information and access to the online registration system, visit <https://www.alamo.edu/spc/experience-spc/current-students/support-centers/disability-services/>.

Good Samaritan Veteran's Outreach & Transition Center - GSVOTC (Off-Site)

For more information contact us at spc-gsvotc@alamo.edu or at 210-486-2185.

We provide free services to active duty service members, veterans, their families and the community. This includes remote referral services, job training, financial counseling, health and wellness, business start-up, academic advisement, and no cost legal services by a licensed attorney. Call us Monday-Friday (8 am - 5 pm). To learn more visit <https://www.alamo.edu/spc/about-spc/college-offices/gsvotc/>.



The Selective Service System reminds all men to register upon their 18th birthdays.

This is the law. Register while you are applying for federal student aid (check "Register Me" on FAFSA). You may be denied benefits or a job if you have not registered. Late registrations are accepted until a man's 26th birthday. A person's citizenship status is not shared. Registration forms are available at <https://www.sss.gov>, and any U.S. Post Office.

Don't forget to complete your 2020 Census Online (use the link found on page 6). Census takers will begin visiting homes that haven't responded to the 2020 Census to help make sure everyone is counted (May-July).



International Student Services

For more information contact Meredith Bess at 210-486-2147.

The campus remains closed due to coronavirus, but teaching, learning, and staff support are provided remotely. Visit the [COVID-19 Update Page](#) or key in <https://coronavirus/www.alamo.edu/> to see the latest updates. Find resources for F-1 and M-1 visa holders at <https://www.alamo.edu/spc/admissions/specific-populations/international-student-services/>. Services include:

- Immigration matters, such as obtaining F-1 student visas, maintaining full-time enrollment, transferring administration of your SEVIS I-20 record between schools, and traveling outside of the United States
- Academic advising available to assist ELL and international students with course and program planning
- Employment restrictions and options and obtaining work authorization
- Adjustment to St. Philip's College and to life in San Antonio and the United States
- Provide letters for verification of your F-1 status for various purposes, such as obtaining a Texas driver's license or identification card

Keep Learning – Learn Here. Learn Now. Aprende aquí. Aprende ahora.

We have a plan to keep students in college and on track in the face of the challenges presented by the COVID-19 crisis. Our **Keep Learning Plan** relieves the financial burden of tuition and fees through scholarships and allows most financial aid to be used for living expenses. **Keep Learning. Learn here. Learn now.** Check eligibility with Records & Registration, Admissions, Business Office, and Academic Advisors at 210-212-5266, or visit <https://www.alamo.edu/keeplearning/>. Students in Continuing Education programs can call Fred Landeros (210-486-7082) about CE Payment Plans. Let us know how we can help!

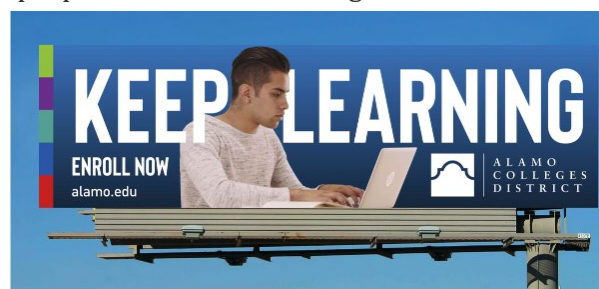

For more information about [Clean Slate](#), [Expanded Summer Momentum](#), or the [Reduced Payment Plan](#) contact the SPC Business Office at 210-486-2200, via email at dst-vbo2@alamo.edu, or visit <https://www.alamo.edu/district/business-office/>.

Up to \$500
CLEAN SLATE

Expanded SUMMER MOMENTUM

Reduced PAYMENT PLAN

Library Resources and Services

For more information contact April Schramm (210-486-2357), or Andrew Rivera (210-486-2564).

[Ask Us](#)

The Library will be offering virtual reference services throughout the summer semester. If you need reference assistance during the summer, use our [ASK US](#) feature and chat service found at the top of the Library homepage at <https://www.alamo.edu/spc/library>.

Update: All checked-out material for the SPC Library is not due until August 31, 2020. This date can be extended if needed. **Please hold on to your checked-out material until the campus reopens and we return to campus. There is no receptacle on campus for drop-off at this time.** See our website for updates and information.

Resources: See our [Distance Education Student Resources Guide](#) for additional help, and [COVID-19 Resource Guide](#) with resources on all-things-COVID-19, as well as fun activities for families and children during this time.

Library Resources and Services (continued)

For more information contact April Schramm (210-486-2357), or Andrew Rivera (210-486-2564).

SPC Archives: We are gathering documentation on how the SPC community is responding to the COVID-19 pandemic, and you can help! If you are keeping a record of your experience working and/or learning remotely, or have any documentation that reflects the current situation, please consider sharing it with the SPC Archives. Your social media posts, blogs, journals, artwork or digital photographs will go a long way to preserving this ever-evolving time in SPC's history. Please contact Rebecca Barnard at 210-486-2583 or rbarnard3@alamo.edu for more information or to contribute.

Summer 2020-Library Virtual Hours:

July 1-July 24

Monday – Thursday: 7:00 am – 7:00 pm

July 27 – August 14

Monday – Thursday: 7:00 am – 7:00 pm

Friday: 7:00 am – 5:00 pm

Hours are subject to change. Refer all inquiries to our [ASKUS](#) feature which will be monitored and answered on these days.

Centers of Excellence for Math & Science

For more information contact Maria Rodriguez at 210-486-7123, or Dr. Jo D. Duncan at 210-486-7121.

The campus remains closed due to coronavirus, but teaching, learning, and staff support are provided remotely. Please visit the [COVID-19 Update Page](#) or key in <https://coronavirus/www.alamo.edu/> for the latest developments. For more information on college and career awareness of science, technology, engineering and mathematics (STEM) call Maria Rodriguez (210-486-7123), or visit our website at <https://www.alamo.edu/spc/academics/academic-resources/academic-centers/centers-of-excellence/>.

Math Labs

For more information contact Renita Mitchell at 210-486-2607.

Virtual MathWorld:

We assist all St. Philip's College math students (credit, non-credit, dual credit and Early College High School) through their math journeys. Instructors help students understand math concepts while building confidence in math skills that carry into the world or work. Remote tutoring services are available for our students in **developmental MATH courses**, as well as **MATH 1314, 1332, 1350, 1351, 1414, 1442, 2412 and 2413**.

Access [Virtual MathWorld](#) by clicking on the link (provided by your instructor) within your current math Canvas course. Here you will find our current schedule of Zoom tutoring drop-in sessions. For more information visit <https://www.alamo.edu/spc/academics/academic-resources/tutoring-centers/mathworld/>, or contact Pete Perez at 210-486-2893, or via email at pperez198@alamo.edu.

Southwest Campus Virtual Math Emporium and Math Bridge Program:

The Mathematics department created a unique experience for students registered in many of the AAS and Certificate programs at Southwest Campus, as well as a tutoring center for students. You can access the [Virtual Math tutoring lab](#) by clicking the link within your summer canvas course. Remote tutoring services are available for our students in all developmental **MATH courses**, as well as **MATH 1332, 1314, 1414, 1350 and 1351**.

St. Philip's College was recently ranked among the top 50 Best Online Community Colleges in the U.S. per collegeconsensus.com. The rating score is based on web presence, transparency, and user-friendliness of learning platforms.



Military Support Services

Serving Active Military & Dependents

For more information contact Betsy Hamilton at 210-486-2610.

St. Philip's College takes pride in providing courses for our active military community on Joint Base San Antonio. However, in response to the pandemic, all face to face student support services at all JBSA locations have been suspended and all summer courses scheduled for JBSA sites have been converted to distance learning until further notice. Please visit our websites below for updates on fall JBSA programming.

Online Zoom Support

Join us during #ZoomTuesdays from 1100-1300 for live support from a MSS team member or request a private Zoom session by emailing the team! We can't wait to see you!

Email Support: dst-military@alamo.edu

Phone Support: Monday-Friday from 0800-1700 at the following numbers:

Fort Sam Students	Ms. Allison Joubert	(210) 486-2004	https://www.alamo.edu/fortsam
Lackland Students	Mr. Javier Barron	(210) 486-7224	https://www.alamo.edu/lackland
Randolph Students	Ms. Cynthia Jaime	(210) 486-2901	https://www.alamo.edu/randolph
General Information	Ms. Sarai Duran	(210) 486-2001	https://www.alamo.edu/military

Available Remote Services includes, but is not limited to:

- Academic and career exploration and information
- Admission and enrollment services
- Placement and Texas Success Initiative (TSI) questions
- Residency classification & tuition rate issues
- ACES (Student Portal) navigation assistance
- Basic financial aid assistance
- Tuition Assistance (TA) and MyCAA funding help and information
- Graduation applications



Air Force General Education Mobile (GEM) Program

St. Philip's college is an original and continuing participating college in the GEM program. Register for pre-approved St. Philip's College online courses to complete your CCAF degree. Ask your Air Force Education counselor about GEM! Visit our webpage for more information at www.alamo.edu/gem.

Military Spouse Scholarship Program (MyCAA)

The My Career Advancement Account Scholarship Program is a workforce development program that provides up to \$4,000 of financial assistance for licenses, certifications, or Associate's degrees to pursue an occupation or career field. Visit our webpage for more information and to see if you qualify at www.alamo.edu/mycaa.

For more information about remote tutoring visit <https://www.alamo.edu/spc/academics/academic-resources/tutoring-centers/mathemporium/>. You may also contact Paula Englebert by text at 1-830-942-5202, 210-486-7241, or via email at pengelebert@alamo.edu.

Phi Theta Kappa Honor Society

For more information contact Maria Botello at 210-486-2199.



Students who have a cumulative (overall) GPA of 3.5 or higher and have completed at least 12 college hours are qualified! Graduate with honors by accepting membership! For more information about this award winning honor society, contact a Chapter advisor at <https://www.alamo.edu/spc/experience-spc/campus-life/get-involved/honor-society/> and visit the organization's website <http://www.ptk.org/join.aspx>. Please provide your name, telephone number, email address, and Banner ID when calling or emailing.

St. Philip's College's



Did you have a great experience with a service offered at the college or do you want something addressed? You can now do that with our "Feed the Tiger" form. We want to hear from you and address your concerns. Click on the orange button at <http://spcweb.alamo.edu/feedback/index.html>.

Strategies of Behavioral Intervention

For more information contact Maria Botello at 210-486-2199.

The Strategies of Behavioral Intervention (SOBI) mission is to promote student, faculty and staff success and campus safety. The SOBI protocol guides our college community to recognize, prevent and respond to incidents. Learn more at <https://www.alamo.edu/spc/about-spc/compliance/strategies-of-behavioral-intervention-sobi/>.

CENSUS 2020:

Your response matters:

It is estimated that an undercount of Texas' population by even 1% in 2020 could result in a \$300 million loss of federal funding. To learn how Census data impacts you and your community [click here](#), or visit <https://2020census.gov/>.

Did you know . . .

By law, the Census Bureau cannot release any identifiable information about you, your home, or your business, even to law enforcement agencies. That's protected under Title 13 of the U.S. Code.

When you respond to the census, your answers are kept anonymous. They are used only to produce statistics. To learn more about how we protect your privacy [click here](#), or visit <https://2020census.gov/>.

CENSUS 101: WHAT YOU NEED TO KNOW

The 2020 Census is closer than you think!
Here's a quick refresher of what it is and why it's essential that everyone is counted.

- Everyone counts.**
The census counts every person living in the U.S. once, only once, and in the right place.
- It's about fair representation.**
Every 10 years, the results of the census are used to reapportion the House of Representatives, determining how many seats each state gets.
- It's in the constitution.**
The U.S. Constitution mandates that everyone in the country be counted every 10 years. The first census was in 1790.
- It's about \$675 billion.**
The distribution of more than \$675 billion in federal funds, grants and support to states, counties and communities are based on census data. That money is spent on schools, hospitals, roads, public works and other vital programs.
- It's about redistricting.**
After each decade's census, state officials redraw the boundaries of the congressional and state legislative districts in their states to account for population shifts.
- Taking part is your civic duty.**
Completing the census is mandatory: it's a way to participate in our democracy and say "I COUNT!"



Congratulations!

You have been issued a VIP FASTPASS.
Use this VIP FASTPASS to rush through the
Project QUEST Enrollment Process.

Get help with your Summer/Fall 2020 tuition,
books, uniforms, licensing and more!
Support Services also available, if eligible.

Send email NOW to apply - Erika@QuestSA.org.
Include your name, your training program, and name of
QUEST participant that referred you.



Introducing the VIP FASTPASS to Training Success!

For more information contact Yolanda Williams at 210-630-4691.

Project QUEST is ready to help, and this VP FASTPASS will ensure that we “rush” new applicants through our enrollment process to get the training assistance just in time for the Summer and Fall 2020 semesters.

To Future QUESTers: Project QUEST helps with financial resources and guidance. Take this opportunity to learn more about Project QUEST and the services we provide, and see how we can help you to achieve your educational and career goals. Apply at <https://www.questsa.org/>.



Abuse can look different
For immigrants. Call our
confidential 24-hour
bilingual crisis/domestic
violence helpline:
651.772.1611.

Learn more at <https://casadeesperanza.org/>.

Records and Registration

For more information contact Tracy Shelton at 210-486-2292.

The staff is dedicated to your success as a student. Contact staff in Records and Registration or Admissions, to get answers about the FERPA Consent, GPA, Summer Momentum, Incomplete “I” Grades, and more. Let us know how we can help by calling us at 210-486-2700.



Stay on track -- connect with your Certified Academic Advisor now. For more information visit <https://www.alamo.edu/spc/academics/academic-calendar/>. See other important dates at <https://myspccatalog.alamo.edu/content.php?catoid=177&navoid=10907#summer-registration-calendar!>

Records and Registration: 210-486-2700, 210-212-5266 Local, or 1-844-202-5266 toll free. Need more Help? Visit <https://www.alamo.edu/spc/academics/academic-resources/academic-advising/graduation-ready/>.

Graduation Information

For more information contact Enrollment Management at 210-486-2700.

Fall 2020 Graduation Applications will be accepted July 1 – October 31, 2020. For more information visit our web page at [alamo.edu/spc/graduation](https://www.alamo.edu/spc/graduation).

Review Graduate Checklist at <https://www.alamo.edu/spc/experience-spc/current-students/graduation/>. For more information on the Advising Institutes, visit <https://www.alamo.edu/spc/academics/academic-resources/academic-advising/>.

Student Conduct/Title IX

For more information contact John Martin at 210-486-2746.

The college remains closed due to coronavirus, but teaching, learning, and staff support are provided remotely. Please visit the [COVID-19 Update Page](#) or key in <https://coronavirus/www.alamo.edu/> to see the latest developments. Updates are posted as soon as they become available.

Note: Students with a T9 Registration Hold - Sexual Assault Prevention for Community Colleges (SAPCC) training is required for all new, returning and transfer students who enrolled at St. Philip's College Spring 2020. Students who have not completed the training will have a Registration Hold (T9) placed on their record. To ensure you do not have a Registration Hold on your record, do the following:

1. Login to ACES
2. Go to the Student Tab
3. Click Web Services
4. Click the Student Tab
5. Click Student Records
6. Click View Holds



If you have a hold, email John Martin at jmartin139@alamo.edu

Include your full name, banner ID# and contact information for prompt response.

<https://www.alamo.edu/spc/about-spc/leadership/president/presidents-newsletters/>

AlamoPROMISE Program - Complete your steps!

We are Admissions, Business Office, Student Financial Aid at 210-212-5266, or Toll Free at 1-844-202-5266.

March 20 was the priority date to complete the remaining steps needed to be considered an AlamoPROMISE scholar in Fall 2020. In sensitivity to the COVID-19 situation, remaining items submitted after the priority date will be considered on a space available basis.

Alamo Colleges District and its partners are committed to ending poverty, enhancing economic and social mobility and meeting workforce demands in our city by joining forces to help more students complete college and obtain the necessary skills to hold high-wage, high-demand jobs. For more information visit <https://www.alamo.edu/promise/about/>.



It is our goal to allow as many eligible students as possible to take advantage of the exceptional opportunity offered by **AlamoPROMISE**. Continue with items 2 and 3.



1. (The period for new "Save Your Seat" application is closed.)
2. File for Financial Aid (Free application for FAFSA or TASFA) by March 20
3. Apply to an ACD College (www.applytexas.org) by March 20

Completing these steps ensures that tuition and mandatory fees at the Alamo Colleges are covered for Bexar County students who graduate from participating high schools. As last-dollar funding, **AlamoPROMISE** covers the gap between financial aid and the cost of tuition for up to three years. Your household income does not disqualify you and because we know plans sometimes change, you are not locked into a commitment.

Need assistance? We are here to help: **St. Philip's College** (210-486-2150), spc-recruit@alamo.edu. Learn more at <https://www.alamo.edu/promise/>, or email the **AlamoPROMISE** team at Promise@alamo.edu for assistance.

Student Financial Aid Office

For more information contact Grace Zapata 210-486-2269.



All financial aid disbursements or refunds due will go out as scheduled. **Call us at 210-210-212-5266**, or reach us via email dst-sfs@alamo.edu. We are here to help! Please have or include your Banner ID when calling or emailing.

The Summer 2020 Financial Aid Application is now available through July 15, 2020. Need help, use the chatbot or see priority dates and deadlines at <https://www.alamo.edu/admission--aid/paying-for-college/financial-aid/priority-dates-and-deadlines/>. In order to be eligible for Summer financial aid, you must:

1. Have a current year FAFSA on file
2. Have completed verification, if selected
3. Be enrolled for a summer term
4. Have submitted a summer application request online from their ACES account

Financial Aid TV is available 24/7. Get your financial aid questions answered with **FaTV** using videos on all the important topics. Browse by category, or search our library of videos. **FaTV** can be found at <https://www.alamo.edu/admission--aid/paying-for-college/financial-aid/financial-aid-tv/>.

Need help completing the TASFA? No problem! Contact Carmen De Luna Jones at 210-485-0280 for assistance.

SPC Health Center

For more information contact Eliah Casillas (MLK) at 210-486-2222, or Brenda Major (SWC) at 210-486-7161.

YOU CAN STOP THE SPREAD OF COVID-19

Stay Home. You can still do the following:

- Get supplies like food, medicine, and gas
- Visit a medical provider
- Walk, run, bike

Keep your Distance:

- Wash your hands before leaving home and upon returning
- Stay at least 6 feet from other people
- Do not gather in groups with family/friends
- Stay away from crowded places

Face Masks:

- Wear cloth face mask in public
- Do not touch the front of the mask when removing the mask. Wash your hands afterward.
- Wash cloth masks daily

You are sick:

- COVID-19 symptoms include fever, cough, and shortness of breath
- Contact a medical provider if you have shortness of breath
- Going to the doctor will not cause problems with immigration

COVID 19 Testing/CSA Information

- Free and pay testing sites in San Antonio are at <https://covid19.sanantonio.gov/What-YOU-Can-Do/Testing/List-of-Testing-Locations-in-Bexar-County>
- City of San Antonio COVID-19 Hotline: 210-207-5779

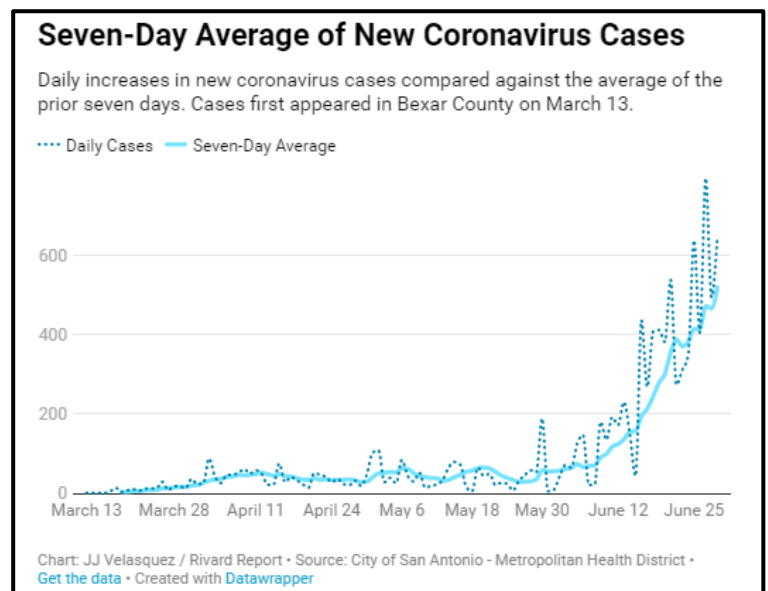

<https://therivardreport.com/bexar-county-sets-record-with-795-new-coronavirus-cases-in-one-day/>

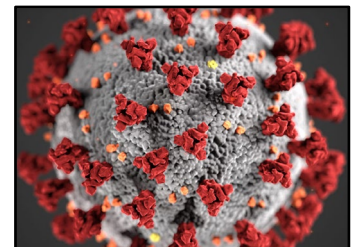

Source: <https://covid19.sanantonio.gov/About-COVID-19>

Student Life

For more information contact Dr. Angela McPherson Williams at 210-486-2090.

Event: Spirit Day
Date/Time: July 8, 15, 22, and 29
Location: Online
Summary: Wear your favorite St. Philip's College shirt or wear school colors – royal blue and white. Like our page and post your picture on Instagram at <https://www.instagram.com/spcspiritandpridecrew/>.

Event: SPC Welcomes New Tigers for the Summer Sessions
Date/Time: July 1 – July 31
Monday/Wednesday 9:00 am – 12:00 pm, and 4:00 pm – 7:00 pm
Tuesday/Thursday 8:00 am – 11:00 am, and 2:00 pm – 5:00 pm

Location: Online
Summary: Please join the ESS Zoom Meetings and the Department of Student Life will assist in helping you with any questions that you may have about St. Philip's College. To join click on the link <https://alamo.zoom.us/j/660619244> or use Meeting ID 660619244.

Event: Cooking with SPC
Date/Time: July 6, 13, 20, and 27 2:00 pm – 3:00 pm
Location: Online
Summary: Please join us for healthy eating tips, watching videos and sharing recipes. To join click on the link <https://alamo.zoom.us/j/92516244256> or use Meeting ID 92516244256.

Event: E-Sports MarioKart
Date/Time: July 2, 9, and 16 6:00 pm – 9:00 pm
Location: Online
Summary: Any student registered for a SPC class may participate in E-Sports MarioKart. Complete the form on the link below and you will receive an email with further instructions. The competition runs on Thursdays (6-9 pm), and the final competition is on July 16. The top three winners will receive cash prizes. To join each event, click on this link: <https://alamo.campuslabs.com/engage/submitter/form/start/416680>.

Event: Wellness Wednesdays
Date/Time: July 1, 8, 15, 22, and 29 2:00 pm – 3:00 pm
Location: Online
Summary: Join us as we celebrate meaningful dialogue about fitness and wellness with students, staff, and faculty at St. Philip's College. To join, click on the link <https://alamo.zoom.us/j/94472074484> or use Meeting ID 944 7207 4484.

Event: AlamoEXPERIENCE
Date/Time: July 1 – July 31
Location: Student ACES Account
Summary: AlamoEXPERIENCE helps you explore your passions, view and RSVP for campus events, get connected with student organizations, and capture your unique involvement experiences by building your Experience Transcript. Click here to explore: <https://alamo.campuslabs.com/engage/> (you'll need to set up your account during your first sign-in).

**CALL FOR
24-HR HELP**

National Human
Trafficking Hotline:
1 (888) 373-7888

San Antonio
Rape Crisis Center:
(210) 349-7273

Centro Seguro
Drop In Center:
(210) 340-8090

San Antonio Police
(Non-Emergency):
(210) 207-7273

San Antonio Fatherhood Campaign:

3014 Rivas St., Suite #20 (78228); Fatherhood
Hotline/Office Line: 210-227-3463

The campaign is providing limited services at this time. Call for assistance. Support and resources for fathers, mothers, and free diapers for families with children under 3 years of age. For more information contact Luissana Santibanez (210-227-3463), or visit <http://safatherhood.com/programs-activities/>.

National Teen Dating Abuse Helpline:

1-866-331-9474, or 1-866-331-8453 TTY.
Text **loveis** to 22522, or visit
www.loveisrespect.org.

*Wellness
Wednesdays*

Student Life (continued)

For more information contact Dr. Angela McPherson Williams at 210-486-2090.

Event: Guidebook
Date/Time: July 1 – July 31
Location: Guidebook App
Summary: Guidebook is a personalized phone application that allows you to stay connected to the Department of Student Life while on the go! When students download our exclusive SPC Student Life guide, they'll receive real-time push notifications, access to event links, and need-to-know engagement information. Get our guide here: <https://guidebook.com/g/spcdsl>.



Android and iOS users:

1. Tap the "Download" button to download the free Guidebook app
2. Open Guidebook and you can find our "St. Philip's College Department of Student Life" guide

We look forward to connecting with you virtually!



Dr. Brownlee speaks on the role that educators have in holding conversations that share the truths surrounding the issues of racism, equality, injustice, systematic prejudices and unconscious bias present in our society. Read more at <https://www.edsurge.com/news/2020-06-09-racism-consumerism-and-a-conversation-with-my-son-about-the-future-of-diversity>.

Tutoring Services and Service Learning

For more information contact Elizabeth Castillo at 210-486-2473.

DACA Allies

Speak confidentially to District Coordinator Carmen De Luna Jones (210-485-2080), SPC Director Liz Castillo (210-486-2473), or SPC Counselor Rosalinda Rivas (210-486-2117). Find additional resources for Deferred Action for Childhood Arrivals (DACA) at <https://www.alamo.edu/spc/admissions/specific-populations/daca/>.

Financial Literacy Program

Event: Free Online Financial Coaching

Date/Time: By appointment

Location: <https://www.aie.org/coaching/>

Summary: This free service, in partnership with Trellis, is designed to help you make smart financial decisions. For more information contact Enida Rehome (210-486-2140).

Tutoring Services

You can still reach us at 210-486-2527. During remote learning, tutoring is available online with St. Philip's tutors through **Brainfuse** or **Zoom**. Subjects offered and tutor email addresses are listed at <https://www.alamo.edu/spc/academics/academic-resources/tutoring-centers/tutoring-and-technology-center/>.

Brainfuse online is provided free through your Canvas course and is available 24/7, with support for students with disabilities (online one-on-one tutoring help). Additional resources for distance learners are at <https://www.alamo.edu/spc/academics/distance-learning/>. Let us know how we can help!



Alamo Colleges District Family,

Immigrants played a vital role in our nation's success pre-COVID and will continue to as our country transitions from response to recovery during this pandemic. DREAMers — immigrants brought to the U.S. as children — are eligible for the Deferred Action for Childhood Arrivals (DACA) program, which was terminated by the Trump administration and has been the center of years of litigation. This week, the U.S. Supreme Court ruled to preserve DACA, temporarily protecting DREAMers from deportation. The Alamo Colleges District and our family of colleges — Northeast Lakeview College, Northwest Vista College, Palo Alto College, St. Philip's College and San Antonio College — celebrate the Supreme Court's decision.

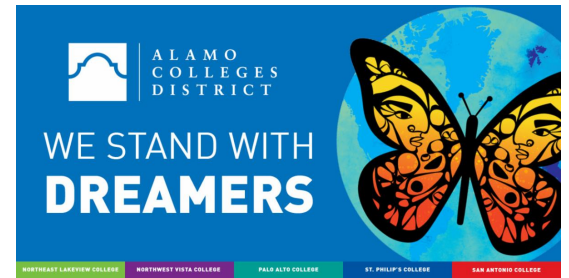

Focused on students and empowering our diverse communities for success, the Alamo Colleges leadership in 2017, and again in 2019, declared their support for our DREAMers students, faculty and staff, recognizing the valuable contributions they provide to the region. As part of this support, we established a DACA/DREAMers resource website, a districtwide DREAMers Advisory Council that consists of administrators, faculty, frontline staff, advisors/counselors and campus police, and enrollment support services tailored for DREAMers.

Our nation, and especially Texas, relies on and benefits from, the economic contributions of DREAMers. Approximately 107,000 DACA recipients live in Texas, the second highest population of DREAMers nationwide. DREAMers also matriculate in our Texas institutions of higher education at a high rate — 66,000 total in Texas. These men and women contribute to the vitality of our economy, attend our colleges and universities, work in key industries and improve our quality of life. They are hardworking individuals that include nearly 27,000 healthcare workers nationwide who have been fighting on the frontlines against COVID-19.

The Supreme Court's decision, while positive, is not the final step. Without a legislative solution to the DACA program, DREAMers, the schools they attend, and the businesses which employ them, will continue to face uncertainty about the future. Now more than ever, our community is relying on a stable workforce to make the everyday decisions that will contribute to the economic recovery of our region. DREAMers deserve a legislative solution that allows them to fully participate in our society.

We commit to our DREAMers students, faculty and staff to remain welcoming and open to all and continue to urge congress to find a legislative resolution for DACA.

In Service,

Marcelo Casillas, Chair of the Alamo Colleges Board of Trustees
Dr. Mike Flores, Chancellor
Dr. Veronica Garcia, President of Northeast Lakeview College
Dr. Ric Neal Baser, President of Northwest Vista College
Dr. Robert Garza, President of Palo Alto College
Dr. Adena Williams Loston, President of St. Philip's College
Dr. Robert Vela, President of San Antonio College

UTSA Dreamers Resource Center, 210-458-7777
Free Virtual DACA Renewal Clinic (July 2nd, 3pm - 4:30pm)

Clínica Gratis de DACA organizada por El Centro de Dreamers de UTSA y American Gateways, 2 de Julio 3pm – 4:30pm.

Join via Zoom/Únase por Zoom Meeting ID/Clave de reunión: **970 8927 9953**
Password/Contraseña: **2&qP8i**

Alamo Colleges District Family,

In the midst of a worldwide pandemic and international protests advocating for Black lives, our U.S. Supreme Court has affirmed what so many of us have believed, that companies can't and shouldn't discriminate against LGBTQ individuals in the workplace. The Alamo Colleges District and our family of colleges - Northeast Lakeview College, Northwest Vista College, Palo Alto College, St. Philip's College and San Antonio College, express our support of the Supreme Court's landmark decision providing necessary protections for the LGBTQ community.

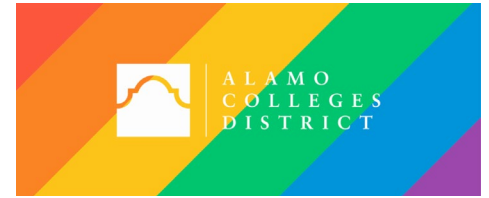

In 2014 and again in 2016, the Alamo Colleges leadership voted and approved explicit policies supporting and protecting our LGBTQ community. Through our Equal Employment and Education statements, we reaffirmed our commitment to prohibit discrimination in any form against students and employees of the Alamo Colleges. For more than 75 years, the Alamo Colleges District has made it our mission to focus on students and empower our diverse communities for success. This week's decision only mirrors what we have been practicing for years and hold as a core value — Respect for All.

While this decision provides more equitable support for the LGBTQ community, our work is not finished. Our nation and state have much to do to dismantle both legal and cultural systems of discrimination.

We will continue to urge our elected officials to enact laws and policies that protect the LGBTQ community.

In Service,

Marcelo Casillas, Chair of the Alamo Colleges Board of Trustees

Dr. Mike Flores, Chancellor

Dr. Veronica Garcia, President of Northeast Lakeview College

Dr. Ric Neal Baser, President of Northwest Vista College

Dr. Robert Garza, President of Palo Alto College

Dr. Adena Williams Loston, President of St. Philip's College

Dr. Robert Vela, President of San Antonio College



Veterans Affairs

For more information contact Veronica Griego at 210-486-2540.

Veterans Affairs	Tony Gable	lgable@alamo.edu	210-486-2521 (O-Z)
Certified Ac. Advisors:	Alicia Stolte	astolte2@alamo.edu	210-486-2539 (Gb-N)
	Vincent Garcia	vgarcia365@alamo.edu	210-486-2522 (A-Ga)

We are dedicated to providing the highest quality and comprehensive support to student veterans and their family members in an atmosphere that provides commitment, respect, and academic excellence. The Veterans Affairs office assists students by providing certification of courses and transmitting enrollment information to the Department of Veteran Affairs. For more information contact Veronica Griego (210-486-2540).

New Student Orientation (NSO): New Student Orientation is reserved for students currently enrolling for the Summer 2020 Semester. To view Checklist, online Registration Form, NSO handout, reschedule NSO, Veteran (and dependent family members) and Military Joint Base San Antonio (JBSA) sessions, visit <https://www.alamo.edu/spc/academics/academic-resources/academic-advising/new-student-orientation/>.

Texas Child Abuse Hotline: 1-800-252-5400

Alamo Colleges District Family,

June 18, 2020

Tomorrow is Juneteenth; it is a day that commemorates the ending of slavery in the United States. It's sometimes called Freedom Day because it celebrates the day, on June 19, 1865, when Union Soldiers landed in Galveston, Texas, and shared the news that slavery had ended – more than two years after the signing of the Emancipation Proclamation.

It's disheartening that for two years African-Americans toiled and remained enslaved when their freedom had already been officially granted. But, what is more devastating, is that 155 years later our African-American community still isn't completely free. More than a century and a half after the end of slavery, black people are still being mistreated, discriminated against and unjustly killed. Black people in our country don't feel free to jog in their own neighborhoods for fear of ending up like Ahmaud Arbery, they don't feel the freedom of safety in their own homes for fear of ending up like Breonna Taylor and some individuals don't feel free to simply breathe like Eric Garner and George Floyd. We have heard these feelings echoed within our community and within our Alamo Colleges District family.

As we approach Freedom Day, we want our African-American students, faculty and staff to feel free within our organization, but even more to feel valued. This means that, at the Alamo Colleges District, Black Lives Matter! Black lives matter to our Alamo Colleges family and to our community, as evidenced by the protests and dialogues that have been happening all around us over the last few weeks. And Black Lives Matter to our faculty, administrators and staff. But these need to be more than words. We must translate them into actions.

In keeping with our mission to “empower our diverse communities for success,” and, in light of recent events and the weight of history, the board and the district leadership of the Alamo Colleges District and its colleges is rededicating itself as an advocate and champion for our communities of color — especially the African-American community.

In a separate email this week you will receive information on some of the actions we are already taking to address equity, diversity and inclusion gaps, and we are planning remote summits to discuss this critical issue and how we should respond to what is happening in our community and country today.

There is a great deal of work to be done, but I have faith that we have the skill, resolve and perspective from diverse experiences to meet this challenge head on, until Black Lives Matter to everyone.

In Service,

Marcelo Casillas, Chair of the Alamo Colleges Board of Trustees
Dr. Mike Flores, Chancellor
Dr. Veronica Garcia, President of Northeast Lakeview College
Dr. Ric Neal Baser, President of Northwest Vista College
Dr. Robert Garza, President of Palo Alto College
Dr. Adena Williams Loston, President of St. Philip's College
Dr. Robert Vela, President of San Antonio College

Volunteer Income Tax Assistance - VITA Program

For more information contact Kenneth Bankston at 210-486-2872.

The campus remains closed due to coronavirus, but SPCs VITA Program is providing remote services at this time. For appointment submission of documents contact us at 210-486-2872, or via email at spc-vita@alamo.edu. We offer **My Free Taxes** to clients that choose to do their own tax preparation. For more information visit our website at <https://www.alamo.edu/spc/experience-spc/community/community-resources/vita/>.

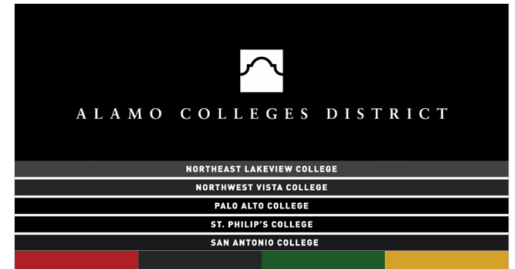

VITA San Antonio Tax Coalition Free Tax Preparation for income \$55,000 or less (Remote Assistance Only)

The following [VITA tax preparation centers](#) (http://vitas.org/?mc_cid=db45cc5dbb&mc_id=0498ef8875) are operating remotely. Must call the centers for appointment submission.

Willie Velasquez Center: 10am - 4pm for appointments only via email or phone. Call 210-207-1711, or 210-207-6575. Email Christine Serda, christine.serda@sanantonio.gov, or Leticia Velasquez, leticia.velasquez@santonio.gov.

Guadalupe Community Center: (8:30am -5pm, drop-off only). Call 210-222-2975 for more information.

Workforce Solutions Alamo - WSA (Off-Site)

For more information contact Rosie Maldonado at 210-582-1826.

American Job Center - We Help with Employment Information and Opportunities. In order to comply with ongoing emergency orders the Workforce Solutions Alamo (WSA) Career Centers have been modified and remain open to clients throughout the city by appointment. We are here to help! The Alamo Region serves Atascosa, Bandera, Bexar, Comal, Frio, Gillespie, Guadalupe, Karnes, Kendall, Kerr, McMullen, Medina and Wilson counties.

All WSA events and job fairs are cancelled due to COVID-19. Inquiries, questions and comments are made by calling 210-272-3260, or completing the **Inquiry form** on our website <https://www.workforcesolutionsalamo.org/>. Expect some delays due to high volume of inquiries.

Workforce Training Network

For more information contact Alfred Landeros at 210-486-7082.

Workforce Training and Certifications - The Workforce Training Network remains closed due to coronavirus, but teaching, learning, and staff support are provided remotely. We offer non-degree courses, certificates, and industry specific certifications. To learn more about career, job training and continuing education that can meet your goals contact Alfred Landeros (210-486-7082), or via email (alanderos1@alamo.edu). Please provide your name, telephone number, and Banner ID when calling or emailing. Learn more at <https://www.alamo.edu/spc/academics/wtn/>.

Central Texas Technology Center - CTTC (Off-Site)

For more information contact Janice Roth at 210-486-7410 (or 1-830-609-2106).

The CTTC provides higher education and technical skills training to promote employment opportunities in high demand occupations, and is located in New Braunfels, TX (78130). For more information visit <https://www.alamo.edu/cttc/central-texas-technology-center/>.

Programs include Vocational Nursing (SPC Off-Site); Economic and Workforce Development (Advanced Manufacturing & Logistics, Health & Biosciences, and Science & Technology); and Integrated Basic Education Skills Training. Review the Spring 2020 Course Schedule at <https://www.alamo.edu/cttc/course-scheduleregister/>. Contact us: Becky Cole, Student Advisor, bcole18@alamo.edu (210-486-7422); Leonor Wright, Senior Advisor, lwright3@alamo.edu (210-486-7409); or Janice Roth, Director, jroth5@alamo.edu (210-486-7410). Please provide your name, telephone number and Banner ID, when calling or emailing.

Tell us how we can improve our services by taking our survey at <https://www.surveymonkey.com/r/LL76ZT5>.

Deferred Action for Childhood Arrivals - DACA (Off-Site)

For more information contact Carmen De Luna Jones at 210-485-0280.

We celebrate the Supreme Court's decision with you! The Brackenridge and Harlandale Education Centers remain closed due to coronavirus, but teaching, learning, and staff support are provided remotely. Let us know how we can help with the application process, registration, TASFA, and resources. Call 210-485-0280 or email mdeluna-jones@alamo.edu. Please provide your name, telephone number, and Banner ID when calling or emailing. We have resources for our students, and our Personal Counselors are culturally sensitive and ready to assist at any of **the Alamo Colleges, Counseling Services offices**: NVC 210-486-4466/210-486-4419; PAC 210-486-3750; SPC 210-486-2333; NLC 210-486-5000; and SAC 210-486-1620.



Deferred Action for Childhood Arrivals - DACA (continued)

For more information contact Carmen De Luna Jones at 210-485-0280.

Access state and federal policies, data, immigration and COVID-19 updates, and resources on the **New American Economy** website <https://research.newamericaneconomy.org/report/immigration-and-covid-19/?emci=315d7a0c-fba0-ea11-86e9-00155d03b5dd&emdi=11c2d39e-02a1-ea11-86e9-00155d03b5dd&ceid=5926459>.

Special populations: In effort to provide access to higher education for the entire community, Alamo Colleges District offers programs and support services to help individuals from all walks of life achieve their dreams by way of earning a degree. To locate resources on immigrant rights to advocate for yourself and protect your community, visit <https://www.alamo.edu/spc/admissions/specific-populations/daca/>. View an important immigrant's training video, "Know Your Rights & Family Preparedness". The video can also be viewed in Spanish.

What should I do if I believe an enforcement action has taken place that is inconsistent with this guidance? The Dept. of Homeland Security (DHS) has explained that there are a number of locations where individuals may lodge a complaint with DHS about a particular immigration enforcement action that may have taken place in violation of these or other policies. Locations and instructions are on the DHS website <https://www.dhs.gov/>, the Customs & Border Protection (CBP) website <https://www.cbp.gov/>, or Immigration & Customs Enforcement (ICE) website <https://www.ice.gov/>. You may also contact the CBP Information Center to file a complaint or compliment via phone at 1-877-227-5511, or submit an email through the website at <https://help.cbp.gov/>.

You may contact ICE Enforcement and Removal Operations (ERO) through the Detention Reporting and Information Line (1-888-351-4024), the local ERO office: San Antonio Field Office (210-283-4750), or the online form at <https://www.ice.gov/webform/ero-contact-form>. The Civil Liberties Division of the ICE Office of Diversity and Civil Rights may be contacted at 1-202-732-0092 or ICE.Civil.Liberties@ice.dhs.gov.

Where should I report discrimination if I believe it is taking place in my school? Anyone with information about discrimination occurring in schools, including discrimination on the basis of race, color, or national origin (which may include citizenship or immigration status), may file a complaint by contacting the U.S. Department of Education, Office for Civil Rights via <https://www.state.gov/s/ocr/>, 1-800-421-3481 or TDD: 1-800-877-8339; (for language assistance contact 1-800-USA-LEARN {1-800-872-5327}) or by contacting the U.S. Department of Justice, Civil Rights Division, Educational Opportunities Section via <https://www.justice.gov/crt/educational-opportunities-section>, 1-877-292-3804, or TTY: 1-800-514-0383.

Will enforcement actions ever occur at sensitive locations? DHS has explained that immigration enforcement actions may occur at sensitive locations in limited circumstances, but should generally be avoided. DHS officers and agents from U.S. Immigration and Customs Enforcement (ICE) or U.S. Customs and Border Protection (CBP) may conduct an enforcement action at a sensitive location only with prior approval from an appropriate supervisory DHS official, or if the enforcement action involves exigent circumstances related to national security, terrorism, public safety, or where there is imminent risk of destruction of evidence material to an ongoing criminal case.

Brackenridge & Harlandale Education Centers
For information on IME BECAS Scholarships
Call (210) 485-0280 or (210) 989-5999



Alamo Colleges Foundation – DREAMers’ Scholarship

The **2020 – 2021 Scholarship Application** is online at <https://www.alamo.edu/foundation/scholarships>. DREAMers submit the application online, and retain the application number given to you for use on the Certification form. Submit the Scholarship Certification form to BETC before the deadline. For more information call Carmen De Luna Jones (210-486-0280).

Application Priority Deadline:
Application Final Deadline:

March 29, 2020
September 6, 2020





U.S. Citizenship and Immigration Services

Don't be afraid to ask for help

Immigration relief is available for victims of human trafficking, domestic violence and other crimes. Visit <https://www.uscis.gov/tools/humanitarian-benefits-based-resources/resources-victims-human-trafficking-other-crimes>.

UTSA Dreamers Resource Center

(Student Center for Community Engagement and Inclusion)

The **UTSA Dreamer Resource Center** is celebrating its second anniversary! The Center provides remote support services to Dreamers in navigating academic, mental health and legal resources. Call 210-458-7777, email dreamers@utsa.edu, or visit https://www.utsa.edu/dreamers/about/index.html?mc_cid=87f9bf2c86&mc_eid=0498ef8875.



Migration is beautiful!



FACT SHEET FOR FAMILIES AND SCHOOL STAFF: LIMITATIONS ON DHS IMMIGRATION ENFORCEMENT ACTIONS AT SENSITIVE LOCATIONS

All children have a right to a free public education, regardless of their actual or perceived immigration or citizenship status or that of their parents.¹ Education leaders, teachers, students, and families, have asked questions about guidance that was released by the U.S. Department of Homeland Security (DHS) that limits immigration enforcement actions from occurring at schools and other “sensitive locations.” This DHS guidance is at: <https://www.cbp.gov/border-security/sensitive-locations-faqs>. To respond to those questions, the U.S. Department of Education has worked with DHS to prepare this fact sheet, intended to help parents, families, educators, and other school staff understand the DHS guidance.

In general, DHS has explained that immigration enforcement actions may not occur at or in “sensitive locations.”

These locations include:



Schools, such as known and licensed daycares, pre-schools and other early learning programs; primary schools; secondary schools; post-secondary schools up to and including colleges and universities; as well as scholastic or education-related activities or events.



School bus stops that are marked and/or known to the officer, during periods when children are present at the stop.



Medical treatment and health care facilities, such as hospitals, doctors' offices, accredited health clinics, and emergent or urgent care facilities.



Places of worship, such as churches, synagogues, mosques, and temples.



Religious or civil ceremonies or observances, such as funerals and weddings.



During public demonstrations, such as a march, rally, or parade.

Central Texas Office for Refugees launches new hotline for refugee services

The [Central Texas Office for Refugees](#) (CTOR) launched a hotline to reach underserved refugee populations including Asylees, Cuban/Haitian entrants, and victims of human trafficking. The hotline was created to assist those who might be experiencing barriers to accessing critical services and is available in 5 languages. CTOR can help with food, medical care, cash assistance, housing, employment, English classes, transportation, and more. Visit https://www.rstx.org/who-we-are/ctor.html?mc_cid=cc04aaefee&mc_eid=0498ef8875.

To access the hotline call or text "**Hello**" to 844-286-7797 for locations and more information about CTOR programs. Phone support is available in English, Kinyarwanda, Nepali, Spanish, and Tigrinya. Text support is available in English and Spanish.



The Public Charge Rule took effect Feb. 24, 2020

The Public Charge rule took effect February 24 for all green card applications. It is important to remember a few important things about this rule:

1. The rule doesn't affect everyone, **only** those who are applying for a green card through a family member or employer, or applying for certain non-immigrant visas.
2. The rule **does not affect people** who already have green cards, applying for citizenship, are refugees or asylees, have VAWA status, U or T visa status.
3. The new rule adds certain public benefits to consideration when applying for a green card. The **benefits that USCIS will look at** are: TANF, Social Security Supplemental Income (SSI), food stamps (SNAP), Medicaid, Section 8 housing benefits, and subsidized housing. Benefits received by your U.S. citizen children will not count against you.
4. If the program is not on the list it is not considered under the new rule. Head Start, school lunch, WIC, immunizations, unemployment benefits, or tax credits, **are not benefits** that will automatically be weighed against you under this new rule.
5. There is a new form that will have to be included with your green card application. The new form asks for a lot of information about your household finances, your education, whether you have health insurance, and your credit history.
6. The rule took effect February 24, 2020, so if your application is on file before that time, the new rule won't apply to you. Any benefits you receive before February 24th won't count against you.

Immigrant Legal Resource Center (ILRC) is at <https://www.ilrc.org/>. For more information and resources in languages other than English visit the **Protecting Immigrant Families** webpage: https://protectingimmigrantfamilies.org/know-your-rights/?mc_cid=cc04aaefee&mc_eid=0498ef8875.

		You can respond to the 2020 Census in Spanish. By April 1, 2020, every home will receive an invitation to participate in the 2020 Census. You will have three options for responding: Online. By phone. By mail.
		Usted puede responder al Censo del 2020 en español. Para el 1 de abril del 2020, cada hogar recibirá una invitación para participar en el censo. Usted https://2020census.gov/es.html

Cornell School of Law: 1L Immigration Law and Advocacy Clinic

<https://www.lawschool.cornell.edu/Clinical-Programs/Immigration-Appellate-Law-and-Advocacy-Clinic/1L-Immigration-Law-and-Advocacy-Clinic.cfm>

COVID-19 RESOURCES FOR UNDOCUMENTED IMMIGRANTS

Tangible Support for Undocumented Communities. List of compiled resources for undocumented individuals: <https://immigrantsrising.org/resource/tangible-support-for-immigrant-communities-during-covid-19/>.

Healthcare Access for Undocumented Immigrants:

Though undocumented individuals are typically not eligible for health insurance, there are many free/low-cost clinics that serve the uninsured: <https://unitedwedream.org/2020/03/healthcare-access-for-undocumented-folks-in-the-time-of-covid19/>.

Free Medical Clinic Directory that serve the uninsured: <https://freeclinicdirectory.org/>.

ICE Will Not Make Arrests at Hospitals: “ICE does not conduct enforcement operations at medical facilities, except under extraordinary circumstances. Claims to the contrary are false and create unnecessary fear within communities. Individuals should continue to seek medical care.” Visit: <https://www.ice.gov/coronavirus>.

Responding to COVID-19: New York United Campaign: <https://www.nycic.org/our-work/campaigns/responding-to-covid-19-new-york-united-campaign/>.

COVID-19 AND IMMIGRATION LAW

USCIS COVID-19 Public Charge Notice: USCIS will not consider COVID-19 testing, treatment, or preventive care (including a vaccine if a vaccine becomes available) as part of a public charge inadmissibility determination, even if paid for by a public benefit like Medicaid: <https://www.uscis.gov/greencard/public-charge>. See also Public Charge FAQs COVID-19: <https://coronavirus.dc.gov/release/public-notice-public-charge-rule-faqs-covid-19-information>.

COVID-19 Stimulus Package: What CARE Act Rebates Mean for Immigrants:

<http://wakeforestlawreview.com/2020/04/covid-19-stimulus-package-what-cares-act-rebates-mean-for-immigrants/>.

Understanding the Impact of Key Provisions of COVID-19 Relief Bills on Immigrant Communities:

“The purpose of this policy brief is to provide information on the COVID-19 relief package’s impact on low-income immigrants and suggestions for urgently needed improvements in any future relief bills, with a focus on health, public benefits, economic support, and employment protections. Please note that this is not meant to be a comprehensive analysis of the bill.” See: <https://www.nilc.org/issues/economic-support/impact-of-covid19-relief-bills-on-immigrant-communities/>.

COVID-19 AND HEALTH INSURANCE

How Uninsured Patients Can Get Help During the Covid-19 Pandemic: This article explains how states are expanding eligibility so they can temporarily insure more of their residents during the pandemic. Private insurance companies are also asking Congress to open up enrollment on the federal exchange:

<https://www.pbs.org/newshour/health/how-uninsured-patients-can-get-help-during-covid-19-pandemic>.

Scholarships and Giving Back Opportunities

Student Engagement Grants (SEG): Are you a full-time student? Do you have a GPA of 2.5 or higher? If so, you may qualify for a **\$1,000 Student Engagement Scholarship**. Learn more at <https://www.alamo.edu/spc/admissions/pay-for-college/scholarships/seg/>.



Scholarships and Giving Back Opportunities (continued)

Projects: Other grant projects are Allied Construction Technology (ACT) Community Service, Alamo Institute Student Leaders, Biology Research Project, Byrd Sanctuary Peer Tutors, Campus Tour Leaders, Collegiate 100, Cyber Tigers, Disability Services Peer Provider, Extramurals Sports Program, Jessica's Project, Middle College Project, Peer Mentor Tutoring-Reading & Writing, QEP (What Would You Do?), SPC Community Garden, Spirit & Pride Crew, STEM Advocates, Stinson Air Museum, Student Government Association (SGA), Tiger PAWS (Personal Academic Writing Space), and Volunteer Income Tax Assistance (VITA). Visit <https://www.alamo.edu/spc/admissions/pay-for-college/scholarships/seg/> and connect with the various Project Managers.

2020-2021 Alamo Colleges Foundation Scholarship Application

The health, well-being and continued success of our students is uppermost in our minds during this period of transition to remote teaching and learning. To ensure that our students have the opportunity to apply for much-needed Alamo Colleges Foundation scholarships, the 2020-2021 Alamo Colleges Foundation scholarship application is at <https://www.alamo.edu/about-us/offices-departments/departments/foundation/students/>.

Deadline: September 6, 2020

SPC Scholarship Office

For more information contact Gloria Hernandez at 210-486-2498.

St. Philip's College Scholarships: All students are encouraged to apply online at <https://www.alamo.edu/about-us/offices-departments/departments/foundation/students/>.

Priority Deadline: March 29, 2020

Scholarship Amount: Varies

Final Deadline: September 6, 2020

Harvey Najim Pathways: Must be graduating from a high school in one of these ISD's: East Central, Edgewood, Harlandale, San Antonio, South San, Southside, Southwest, or Somerset. Pursue degree in Cyber-Security, Information Technology, Nursing, or Respiratory Care. For application information call Gloria Hernandez (210-486-2498).

Deadline: N/A

Scholarship Amount: \$2,500

College for All Texans: Educational Aid Exemption Application

For more information contact Alan David Ahmad at 210-485-0613.

The **Educational Aid Exemption** is available to eligible students taking courses toward teacher certification and pays for the tuition and required fees for said coursework in the semester for which it was applied. The **Advisor-Cert-Form** is also available in the Student Financial Services office on your campus. Visit <http://www.collegeforalltexans.com/apps/financialaid/tofa2.cfm?ID=572>.



U.S. Department of Education

The White House Initiative on Historically Black Colleges and Universities

offers full-time internships year-round (spring, summer, and fall). Part-time applicants who can commit to at least

20 hours a week will be considered, although the Initiative prioritizes full-time applicants (32-40 hours a week). Internships are available in Washington D.C. at the U.S. Department of Education, Initiative Headquarters, at <https://www2.ed.gov/students/prep/job/intern/index.html>.

How to Apply: Visit the [Department of Education's Internship page](#) for detailed instructions and the application.

- **Fall Deadline – July 15** (Dates of program: September through December)
- **Winter/Spring Deadline – October 1** (Dates of program: January through May)
- **Summer Deadline – March 15** (Dates of program: May/June through July/August)